

ELLEY LONG MUSIC CENTER

COLCHESTER, VERMONT



ACOUSTICS CONSULTANT:	Cavanaugh Tocci Associates, Inc.
ARCHITECT:	Martin Tierney
OWNER:	Vermont Youth Orchestra Association
OTHER CONTRIBUTORS:	Hallam Engineering, Mechanical Engineers Neagley Chase Construction
CONSTRUCTION COST:	2.0 Million USD
COMPLETION DATE:	2001

The Elley Long Center provides rehearsal and performance facilities for the Vermont Youth Orchestra Association. Part of the U.S. Army Fort Ethan Allen, the building was originally built in 1895 as a riding drill and show hall for the Third U.S. Cavalry. The construction cost at that time was \$20,000. Later renovations converted the building to gymnasium use.

One block away, in the same former Army complex, the building that once served as the officers' horse stables now serves as the main studios for Vermont Public Radio.

The renovation by the VYOA preserves the full volume of the massive riding hall, but subdivides the floor level to create rehearsal rooms, teaching studios, and offices. Visitors enter an indoor street leading to the different music rooms, with the performance hall open through an archway at the far end.

The performance hall features a permanent stage shell to give the orchestra early reflections and provide a strong, clear sound for the audience. Suspended sound reflector panels above the audience area continue the line of the orchestra shell, providing early reflections as well as diffusion.

Walls are treated with a combination of geometric shapes and areas of sound absorption panels to create diffusion. Sound absorbing panels on the upper side walls and at the rear ceiling control reverberation in the 50ft high space.

To stay within the limited budget, the air handling system for the performance space is mounted on the ground outside the building and ducted in through oversized ductwork with duct silencers. Background sound of the system is below NC-25.

Funding for the renovation came from a major gift by Carolyn Long, who has served as volunteer manager of the youth orchestra for 35 years. The Preservation Trust of Vermont also provided a grant, along with many private contributors including Trey Anastasio of the pop group Phish.

The space is also used by other performing groups, including the Vermont Symphony Orchestra. The Vermont Symphony is thrilled with the acoustics of this new space. At their first rehearsal in Elley Long, VSO conductor Jaime Louredo said, "We will never be happy in our other performance spaces."

CRITICAL DATA

Seating Capacity	400
Room Volume	300,000 ft ³
Stage Area	1,750ft ²
Volume / Seat	750 ft ³
Reverberation Time @ 500 Hz	2.1 sec
Noise Level	NC-25

REVERBERATION TIME

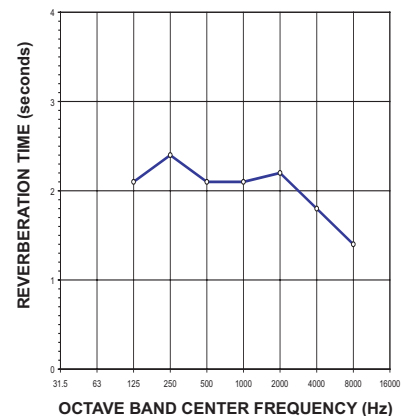

ELLEY LONG MUSIC CENTER

COLCHESTER, VERMONT

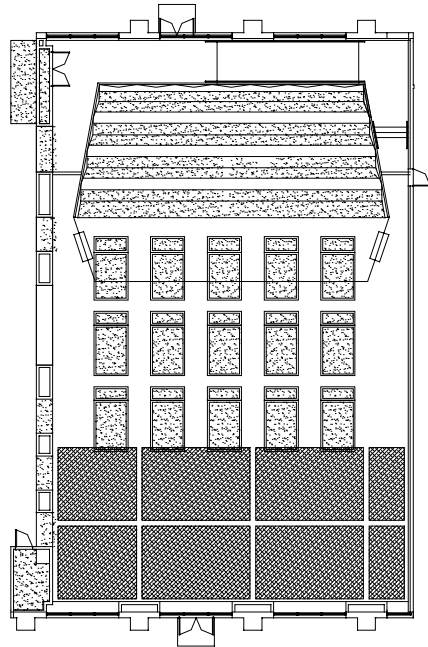

COMPOSITE PLAN



G. HAL



J. SILVERMAN

BACKGROUND NOISE LEVEL

